

Planning Permit No. A/1009/92  
**APPROVED**  
 SUBJECT TO THE CONDITIONS IN THIS OFFICE LETTER.  
 No. A3/1716/92  
 FOR MEMBER SECRETARY  
 MADRAS METROPOLITAN DEVELOPMENT AUTHORITY  
 MADRAS 600 004

**SPECIFICATIONS**  
 FOUNDATION:  
 M.C. COL: 4-8  
 80CM BRICKWORK IN CM 1:2 FOR FOUNDATION AND BASEMENT  
 SUPERSTRUCTURE:  
 80CM BRICKWORK IN CM 1:2  
 RCC UNITS, AND RCC SLAB IN 1:2:4  
 JOINTS:  
 80CM INCH SPACED FOR DOORS, WINDOWS AND VENTILATORS.  
 PLASTERING:  
 WALL PLASTERING IN THE IN CM 1:4 AND CEILING PLASTERING IN THE IN CM 1:3.  
 FLOORING:  
 FLOORING WITH 3/4" IN CM 1:3 INCLUDING THREAD LINING  
 WEATHERING COURSE:  
 BRICK JELLY IN LINE AND TOP LAYING WITH 2 COURSES OF 1:1:6

**SCHEDULE OF OPENINGS**

TYPE	WIDTH	HT	DESCRIPTION
D	200	2100	T.W. FLUSH DOOR
D1	700	2100	T.W. PANELLED DOOR
D2	750	2100	T.W. PANELLED DOOR
W	560	1350	
W1	800	1350	T.W. GLAZED WINDOW
W2	1780	1350	
W3	1900	1350	
V	560	715	T.W. GLAZED VENTILATION
RS	2670	2405	STEEL ROLLING SHUTTER
RS1	2080	2405	

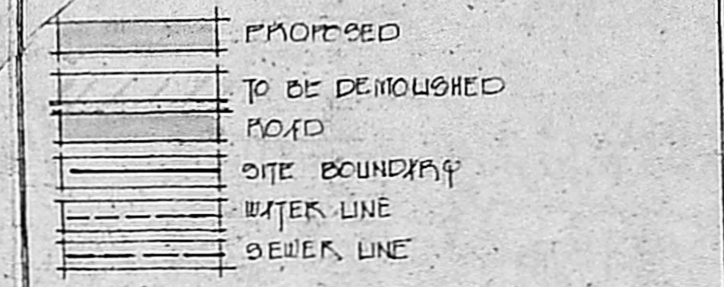

PROPOSED BUNGALOW AT NO. 21,  
 VIJAYANATHARAM FIRST STREET,  
 MANGIRAJAPURAM ROAD,  
 MADRAS - 600 024.  
 P.S. NO. 42/4  
 BLOCK NO 23, PULUPUR DIVISION  
 EGMORE - MANGIRAJAPURAM BLK.,  
 MADRAS DISTRICT.

DETAIL WORKING DRAWINGS  
 PLANS, ELEVATION AND SECTION OF DEMOLITION AND  
 PROPOSAL BLDG. & SITE & TPO PLANS.  
 SCALE: 1/100, 1/200.

DATE: 01/11/91 DWS NO: CP-2  
 ARCHITECTS

MD. MUSTAFA,  
 B.Arch., F.I.I.A., F.I.A.A., F.R.S.A., F.I.T.I.R.A.I.  
 PARTNER  
 JOHNSON AND MUSTAFA,  
 ARCHITECTS  
 GEMS COURT A-6  
 14 KHADER NAWAZ KHAN ROAD,  
 MADRAS 600 006  
 REGISTERED ARCHITECT NO. CA/75/33  
 COUNCIL OF ARCHITECTURE  
 R.A.7

JOHNSON AND MUSTAFA  
 GEMS COURT A-6  
 14, K.N.C. ROAD, MADRAS-6  
 OWNER: Naren Ball